

How Do I

Show Driveway Compliance?

The following illustrations show the essential components of construction plans for a new driveway over 50' in length. For an existing driveway, the applicant can either submit similar plans or a compliance letter from an engineer or surveyor stating the driveway meets or exceeds all Jefferson County Roadway Design and Construction Manual standards.

Driveway Plan page 1 of 2

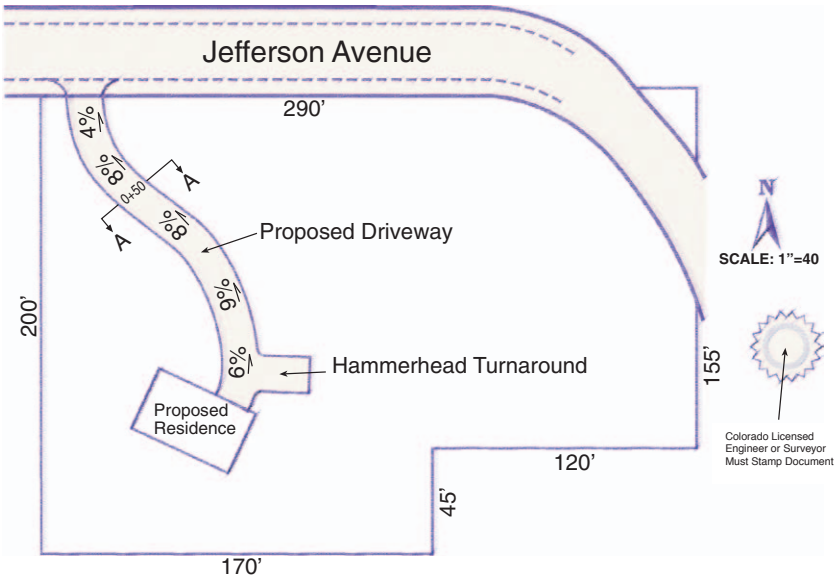

Driveway Plan page 2 of 2

(Please see the back of this sheet for detailed views of these items)

Colorado Licensed Engineer or Surveyor Must Stamp Document

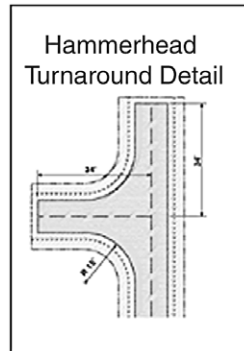
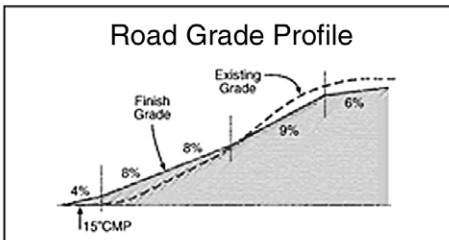
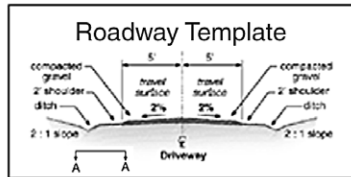

... continued on back



Show Driveway Compliance? . . . continued from other side

Driveway Plan page 2 of 2 details

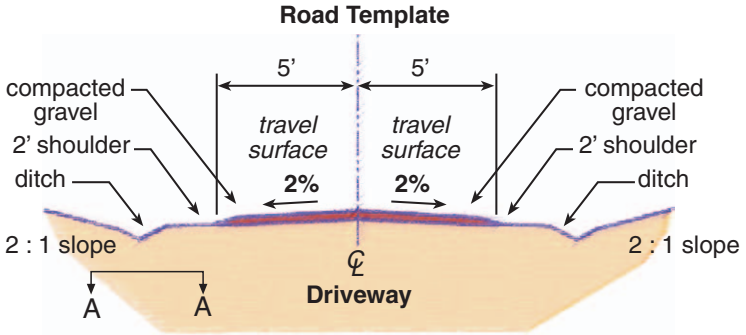

Road Grade Profile – Scale: 1"=50' Horiz. 1"=10' Vert.

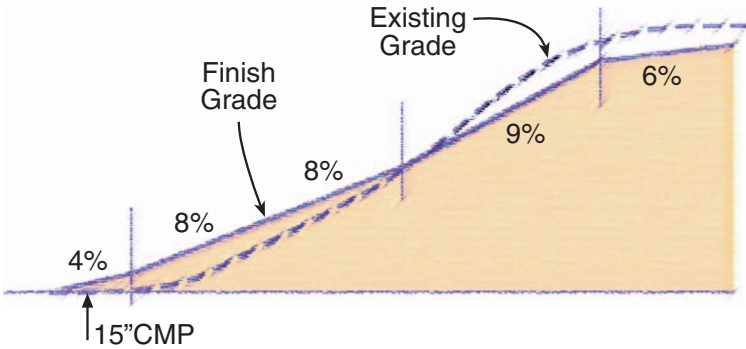

Hammerhead Turnaround Detail

