



Jefferson County Sheriff's Office

Detention Services Division

Detention Services Division Mission Statement

- The Mission of the Detention Services Division is to remain responsive to community needs, maintain a safe and secure facility, and provide varied services and programs for stability and enrichment.

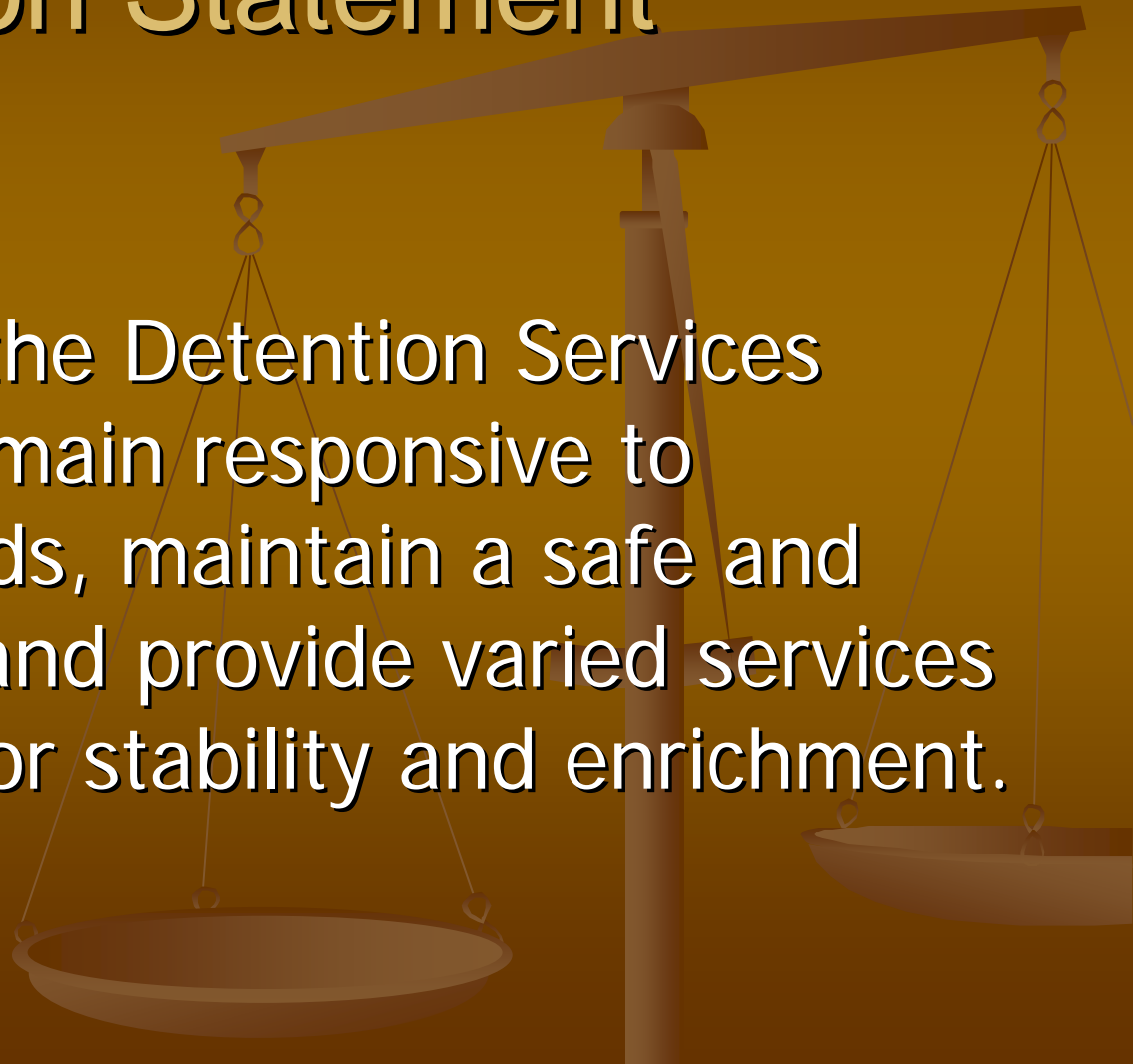

Detention Facility Measurements

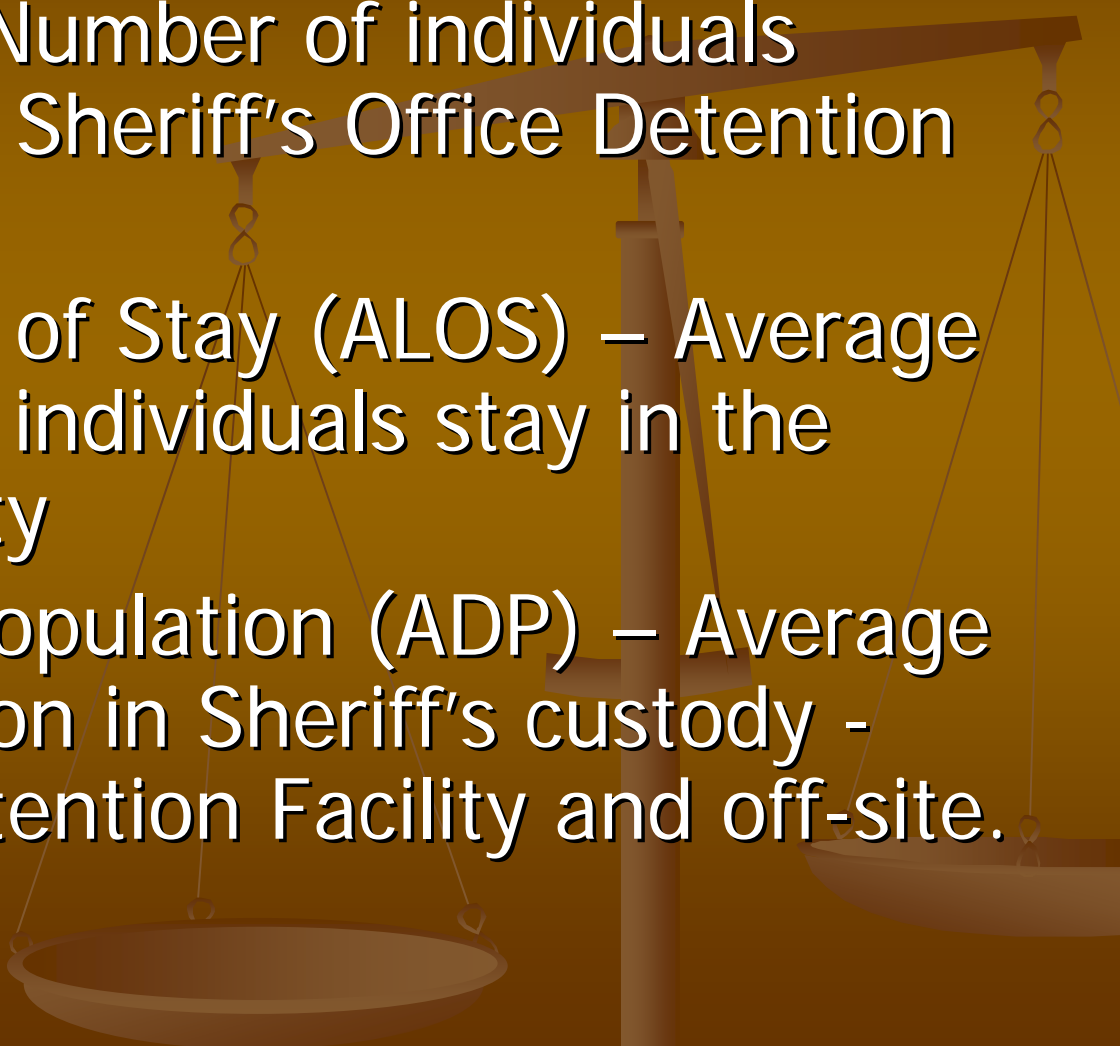
- Bookings (B) – Number of individuals booked into the Sheriff's Office Detention Facility
 - Average Length of Stay (ALOS) – Average number of days individuals stay in the Detention Facility
 - Average Daily Population (ADP) – Average inmate population in Sheriff's custody - includes the Detention Facility and off-site.
- 

Number of Bookings

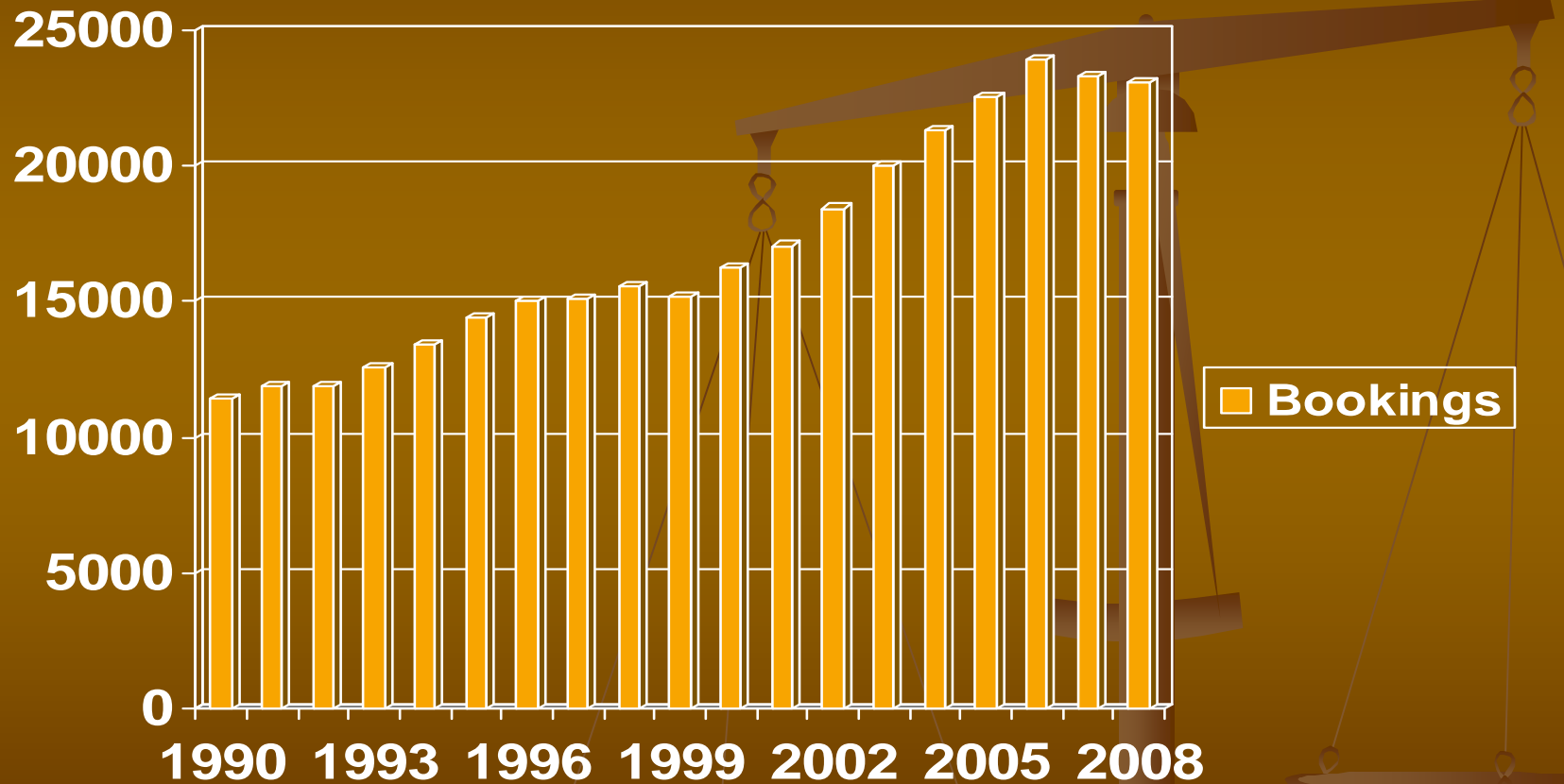

Average Length of Stay

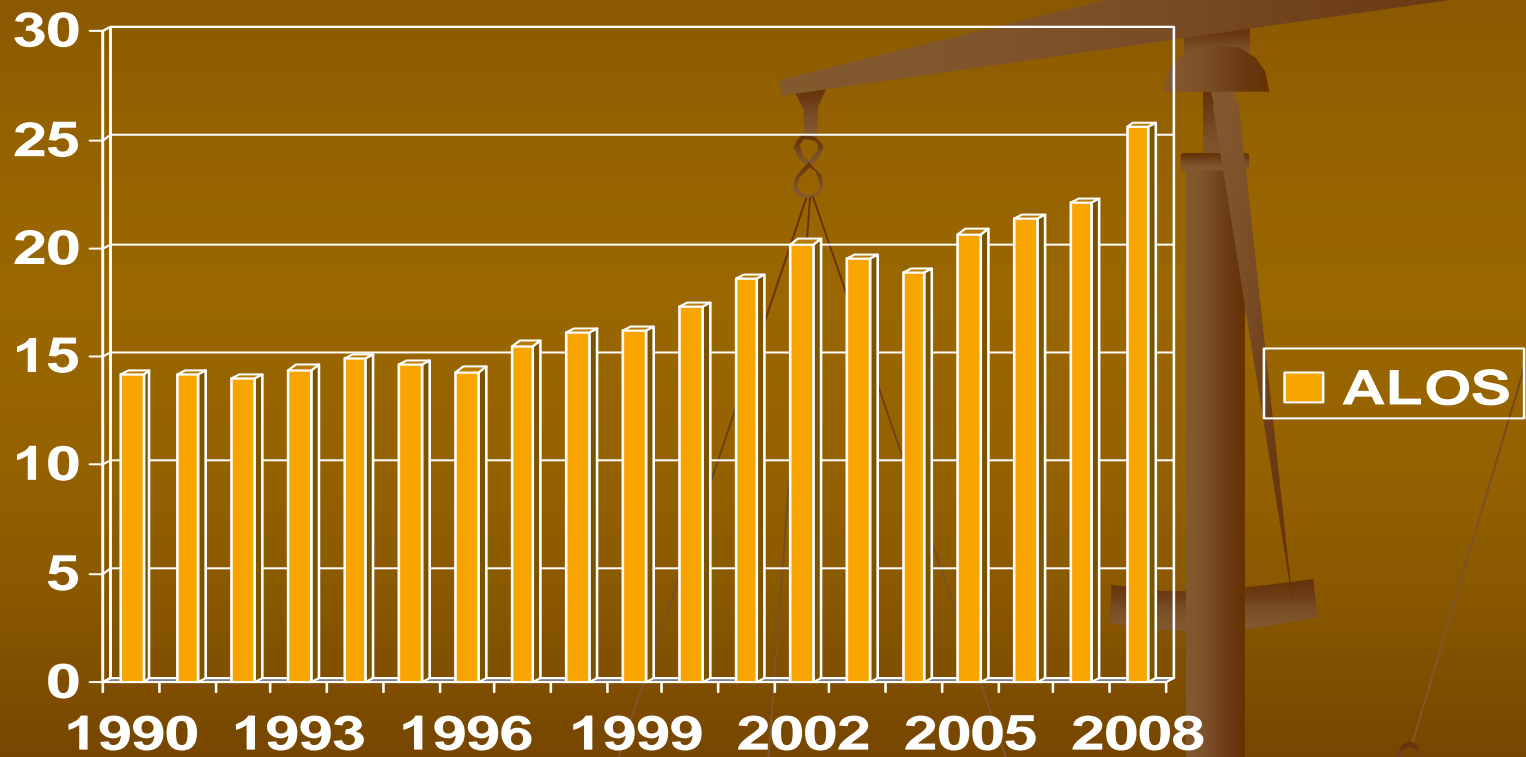

Average Daily Population

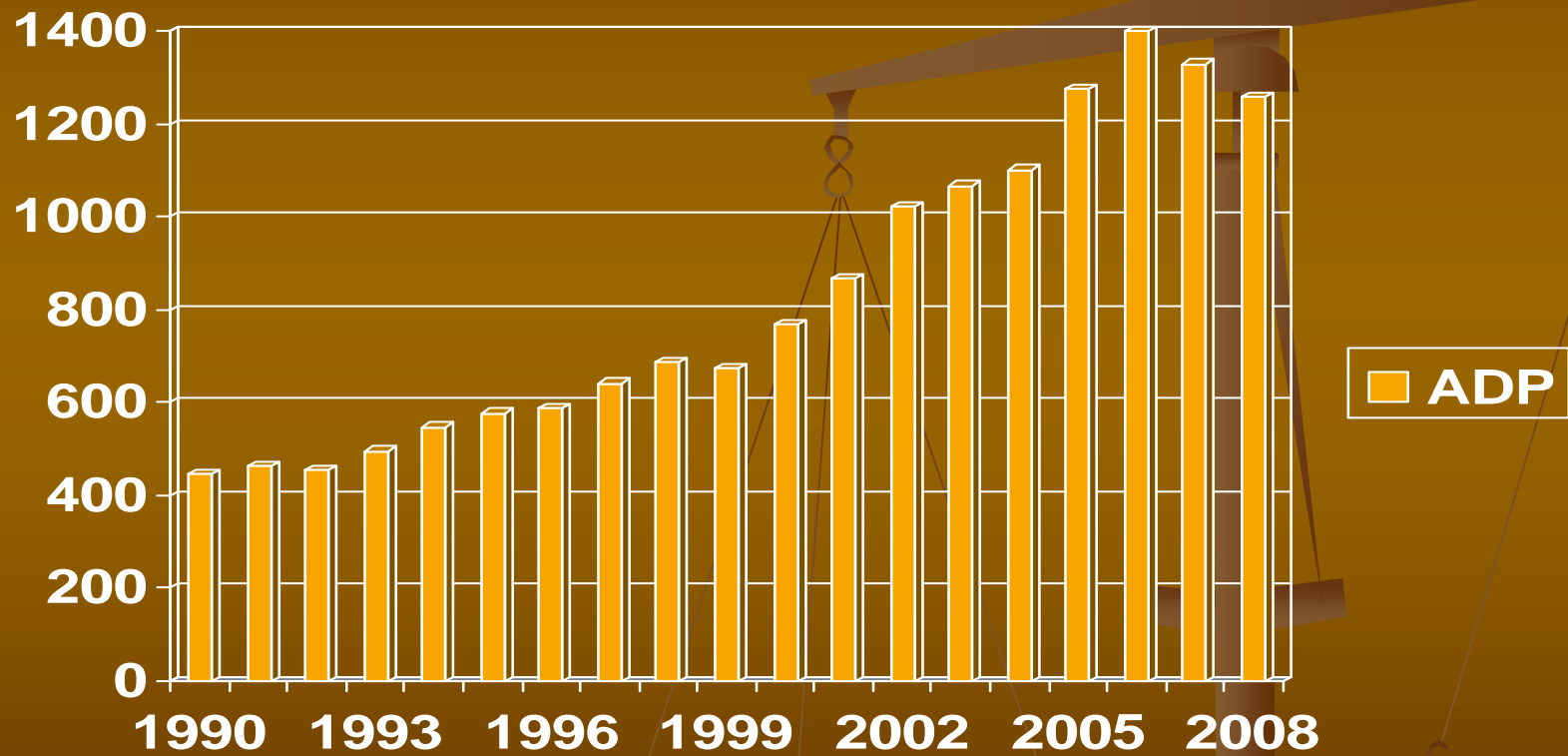

Who is in Sheriff's custody?

■ Males – 85%

Females – 15%

INMATE STATUS

- Sentenced
- Pre-trial
- Convicted
- Contract
- Writ
- Other

CLASSIFICATION

Minimum
Medium
Maximum
Work Release
Special Needs
Classification
Ad Seg/Disciplinary

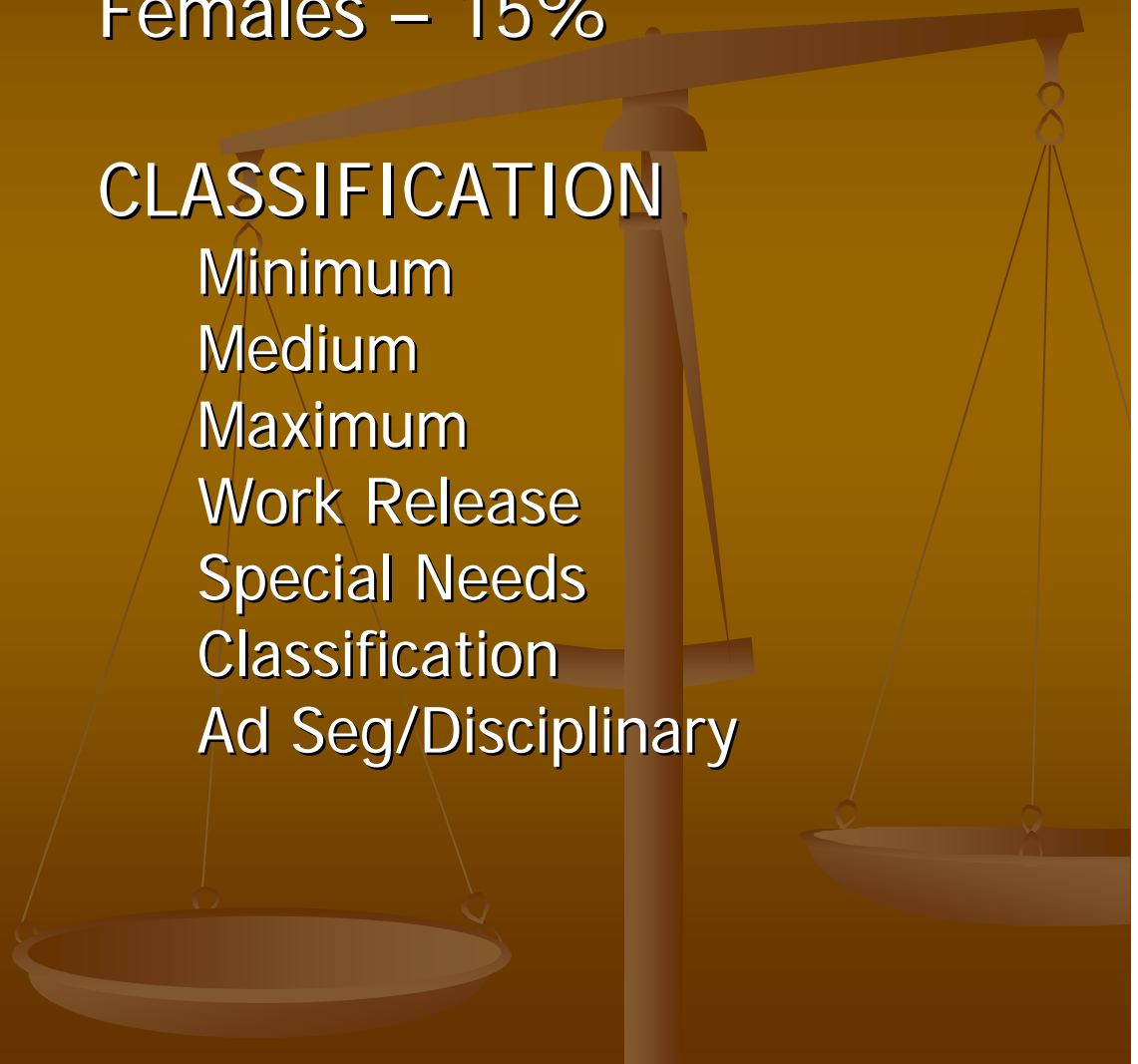

623 Sentenced - Detention Facility

- 237 felonies
 - About ½ in Main Jail
 - Module 7C - sample
 - About ½ in Work Release
 - Module 3B - sample



567 Pre -Trial – Detention Facility

- 439 felonies, 112 misdemeanors, 16 other
- Arrest standards, bond schedule (community safety is goal)
 - Module 6B – maximum security – sample
 - Module 5A – minimum security – sample

Sample Population

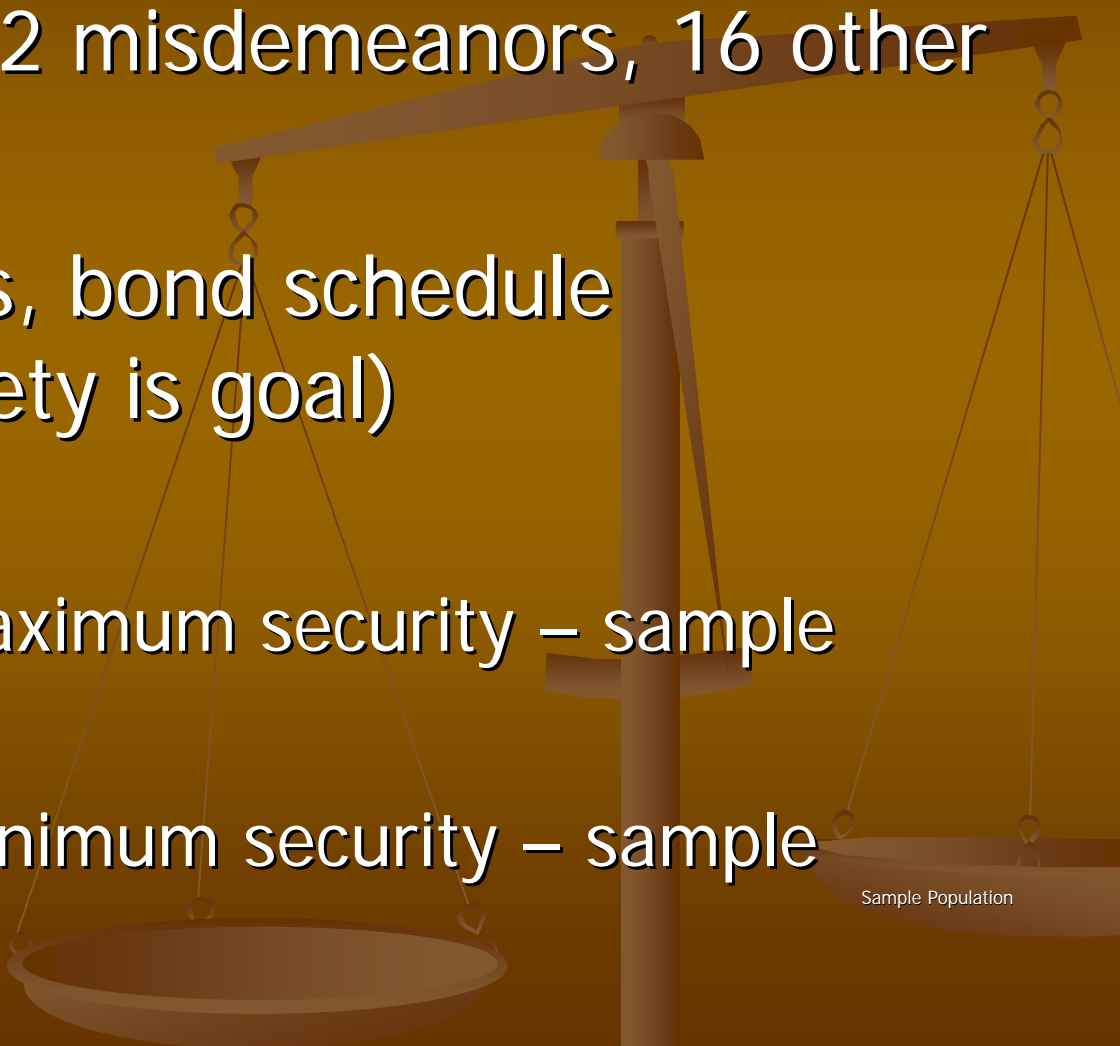

2007 Revenues



■ USM/ICE	\$2,234,303
■ Work Release	1,139,700
■ Inmate Telephone	456,652
■ Booking Fee	370,681
■ State Parole/DOC	338,111
■ Commissary	226,941
■ Bond Fee	93,901
■ Medical Co-Pay	48,040
■ Social Security	29,800
■ Total	\$4,938,129

2008 Revenues

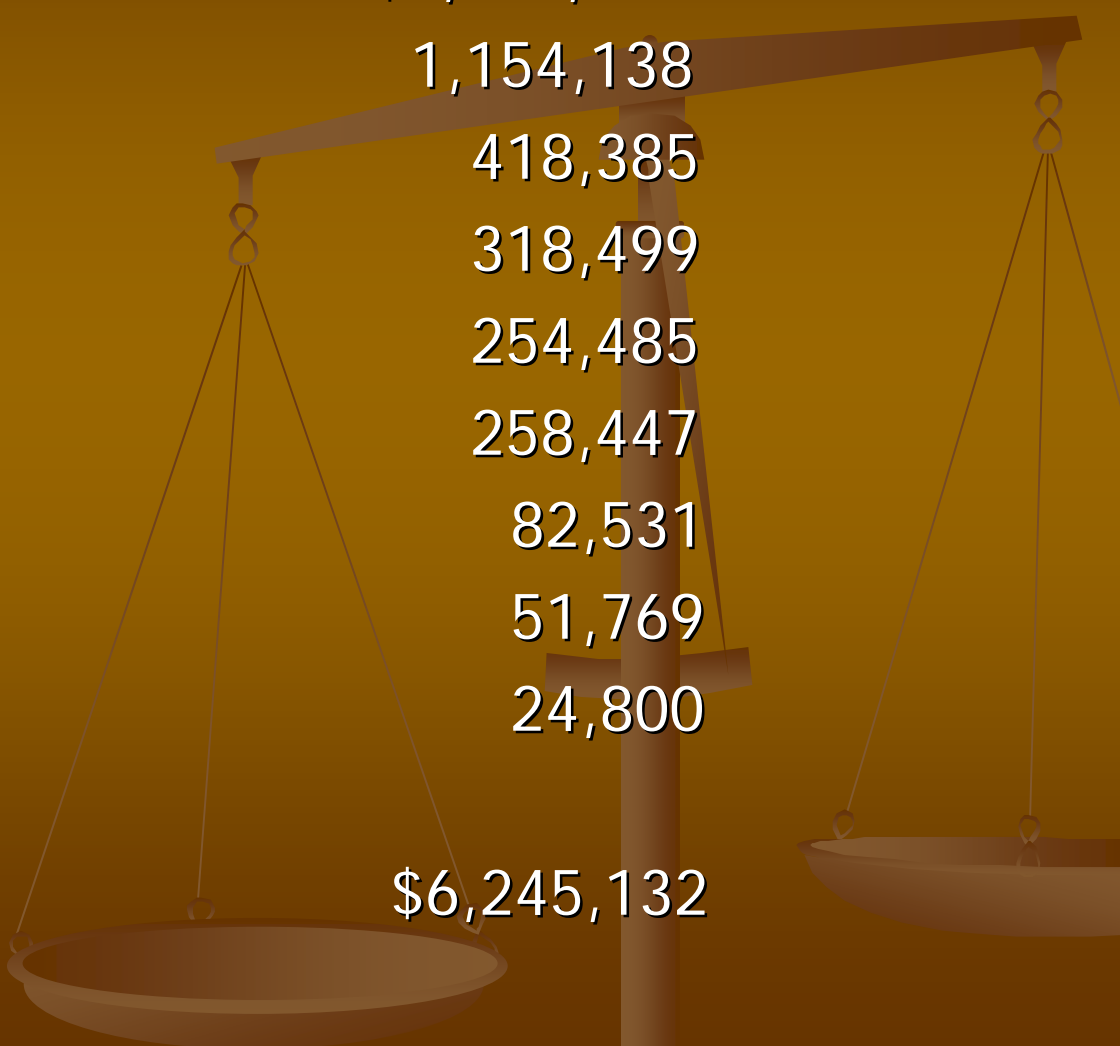

■ USM/ICE	\$3,682,078
■ Work Release	1,154,138
■ Inmate Telephone	418,385
■ Booking Fee	318,499
■ State Parole/DOC	254,485
■ Commissary	258,447
■ Bond Fee	82,531
■ Medical Co-Pay	51,769
■ Social Security	24,800
■ Total	\$6,245,132

Jefferson County Sheriff's Office



2025 Master Plan

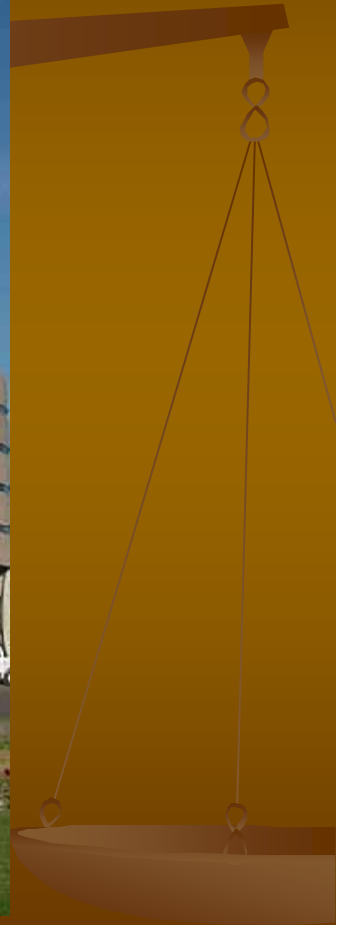

Sheriff's Office Complex

- Opened in 1986
- 422 Beds (single – bunked)
- All LE Services



1990's

- Addition of permanent double – bunking to increase capacity, use of sled beds
- Courts and Administration Building opens in 1993 (Courts, Post 5/Tunnel)
- Early releases (i.e. % of sentence completed)
- Reilly Johnson Architecture contracted to design the Direct Supervision Facility (add 768 beds)

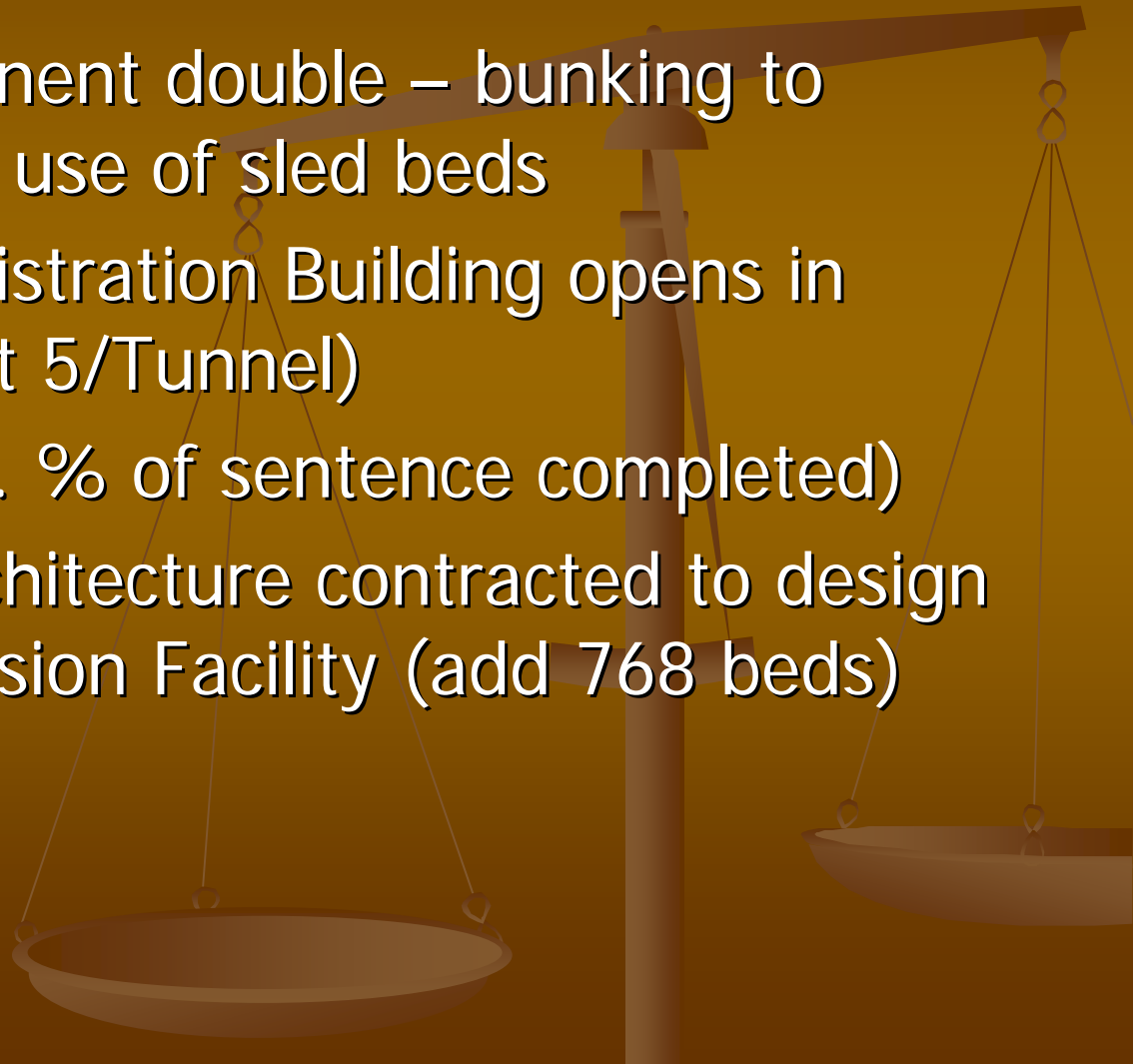

August, 2001

- Direct Supervision Facility Opened
- 768 Beds (direct supervision and efficient)
- 2010 (population, staffing)

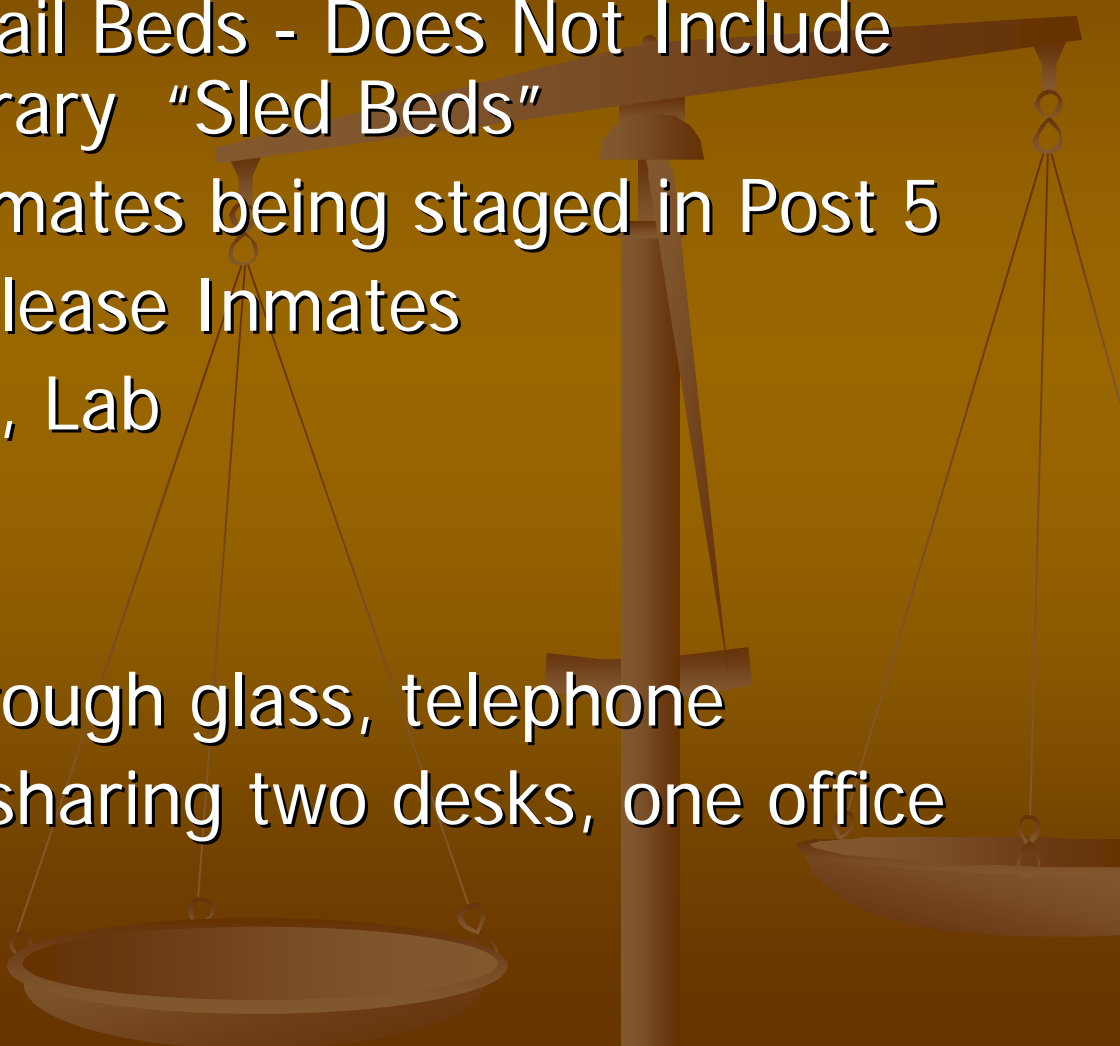

Facility Is At Capacity Now

- 1326 Permanent Jail Beds - Does Not Include the Use of Temporary "Sled Beds"
 - Up to Fifty (50) inmates being staged in Post 5
 - 192 Male Work Release Inmates
 - Evidence, Records, Lab
 - Central Plant
 - Parking
 - Visitation done through glass, telephone
 - Up to five people sharing two desks, one office
- 

Master Plan Project

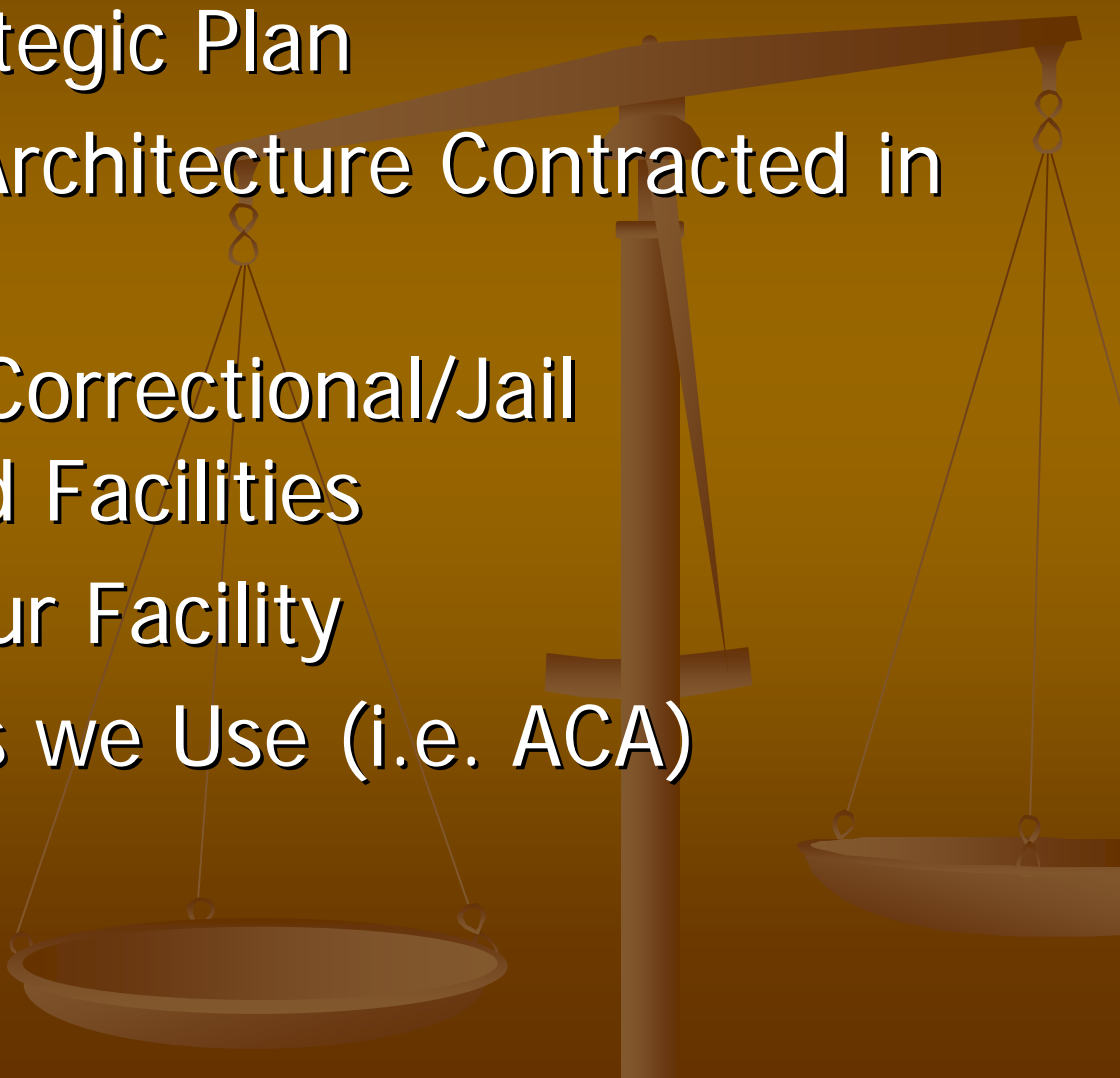
- Long-Term Strategic Plan
 - Reilly Johnson Architecture Contracted in May 2006
 - Experienced in Correctional/Jail Architecture and Facilities
 - Familiar With Our Facility
 - Know Standards we Use (i.e. ACA)
- 

Master Plan Approach

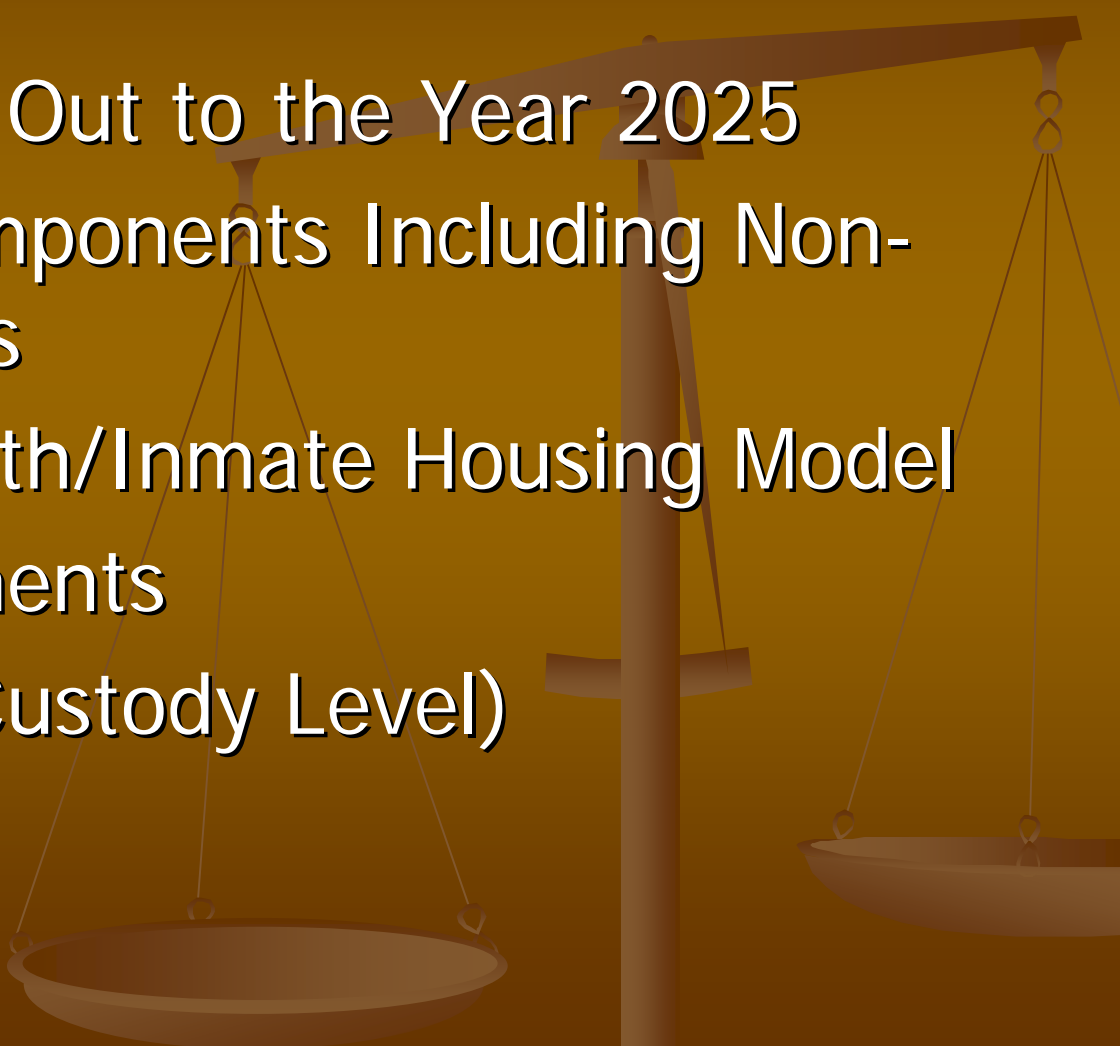
- Estimate Needs Out to the Year 2025
 - Examine All Components Including Non-Detention Needs
 - Projecting Growth/Inmate Housing Model
 - Space Requirements
 - Efficiency (i.e. Custody Level)
- 

Flexibility of the Plan – Phase One and Phase Two

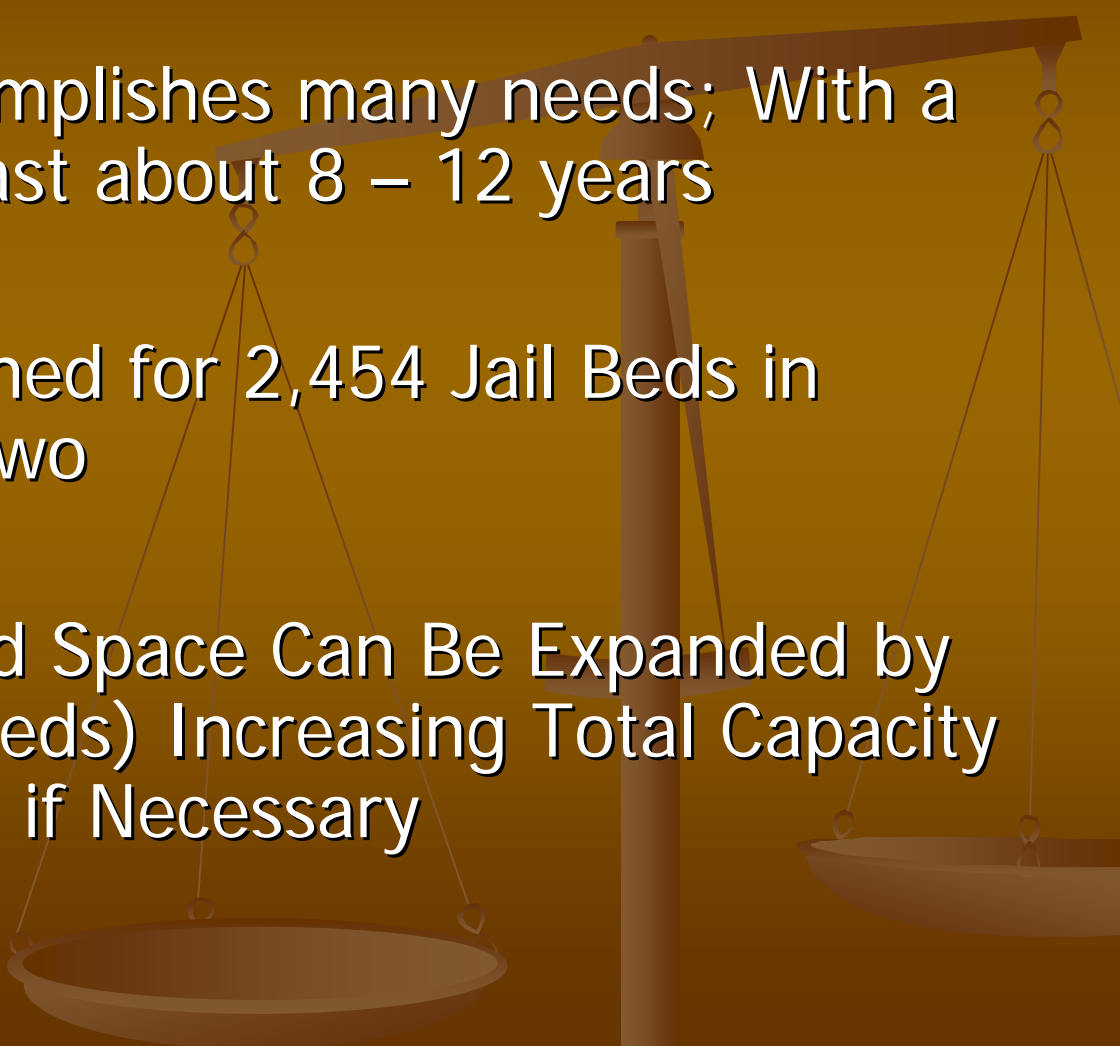
- Phase One – Accomplishes many needs; With a use plan, should last about 8 – 12 years
 - Master Plan Designed for 2,454 Jail Beds in Phases One and Two
 - Phase Two Jail Bed Space Can Be Expanded by 25% (about 600 beds) Increasing Total Capacity to 3,100 Jail Beds, if Necessary
- 

Phase One

- 1A Central Plant
- 1B Post 5 Expansion
- 1C-D Work Release/ICCS
648 Total Beds
- 1E Lobby Remodel
- 1F Briefing Room/Office
- 1G Evidence Vault
- 1H Crime Lab
- 1I Records
- 1J Laundry
- 1K Parking Structure 450
- 1L Rec. Areas Main Jail

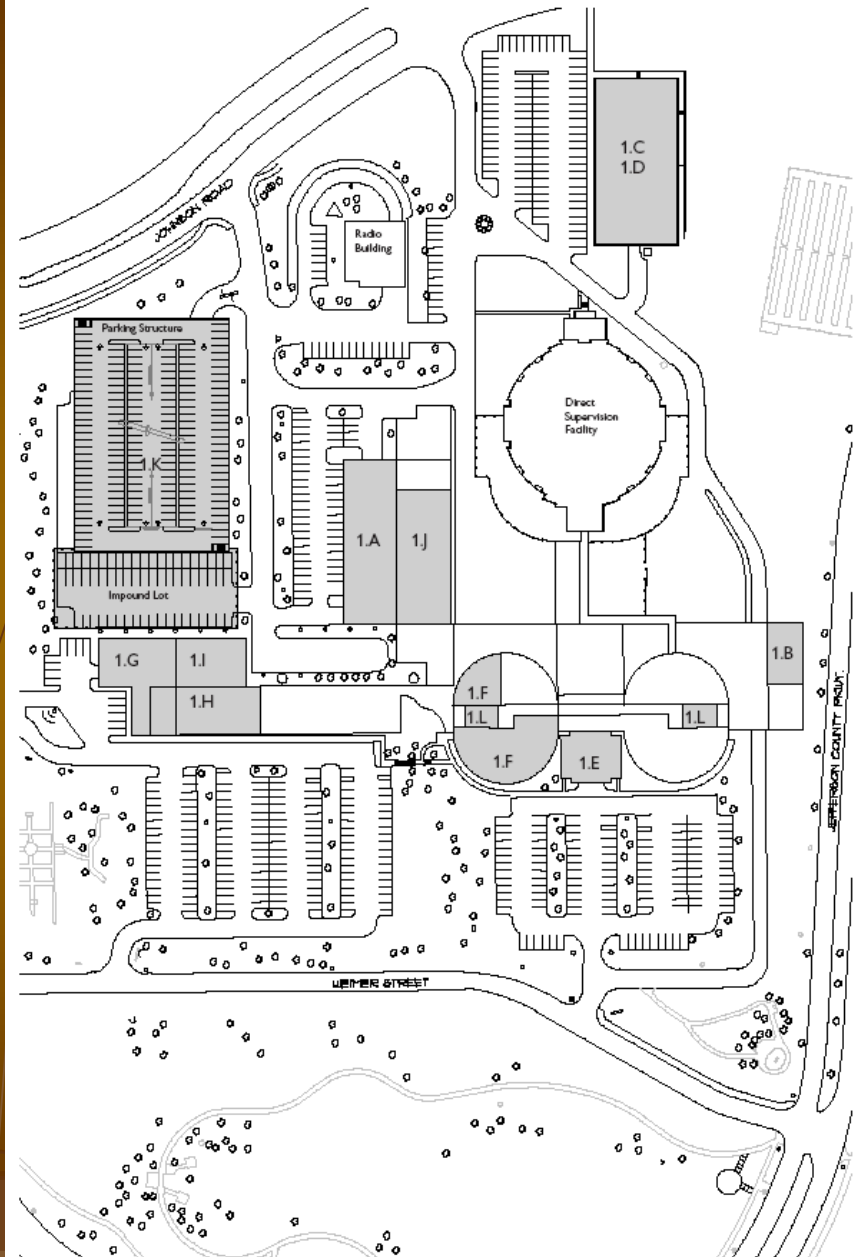

Central Plant

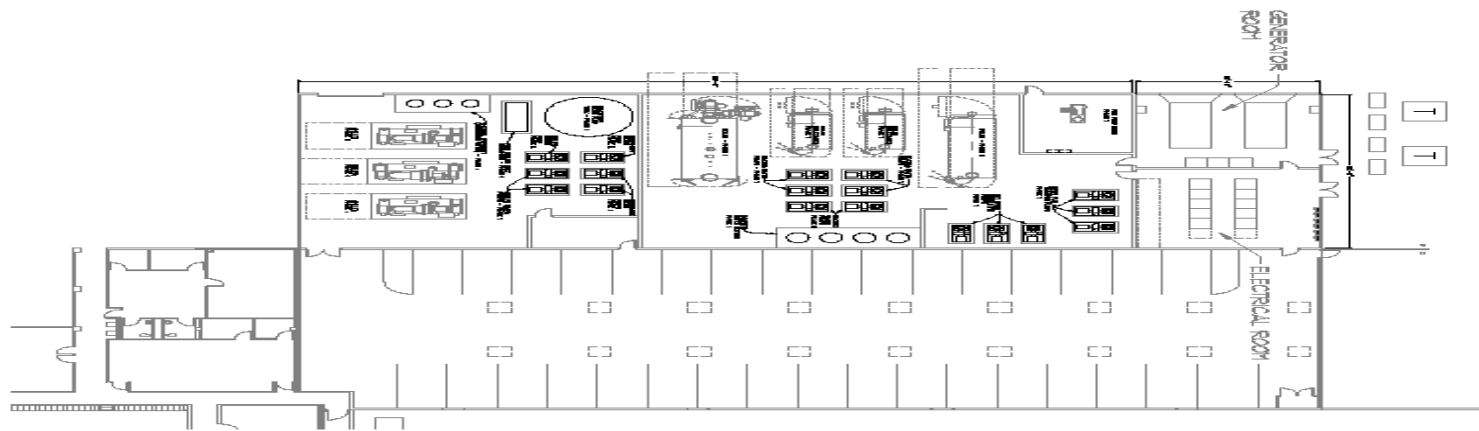

Work Release/ICCS Building and Parking

- Work Release Building
50,000 Total S.F.
- 2 Stories
- 352 Beds Lower Floors
- Community Corrections
(ICCS) 45,000 Total S.F.
- 3 Stories
- 256 Beds Upper Floors
- 91 Parking Spaces

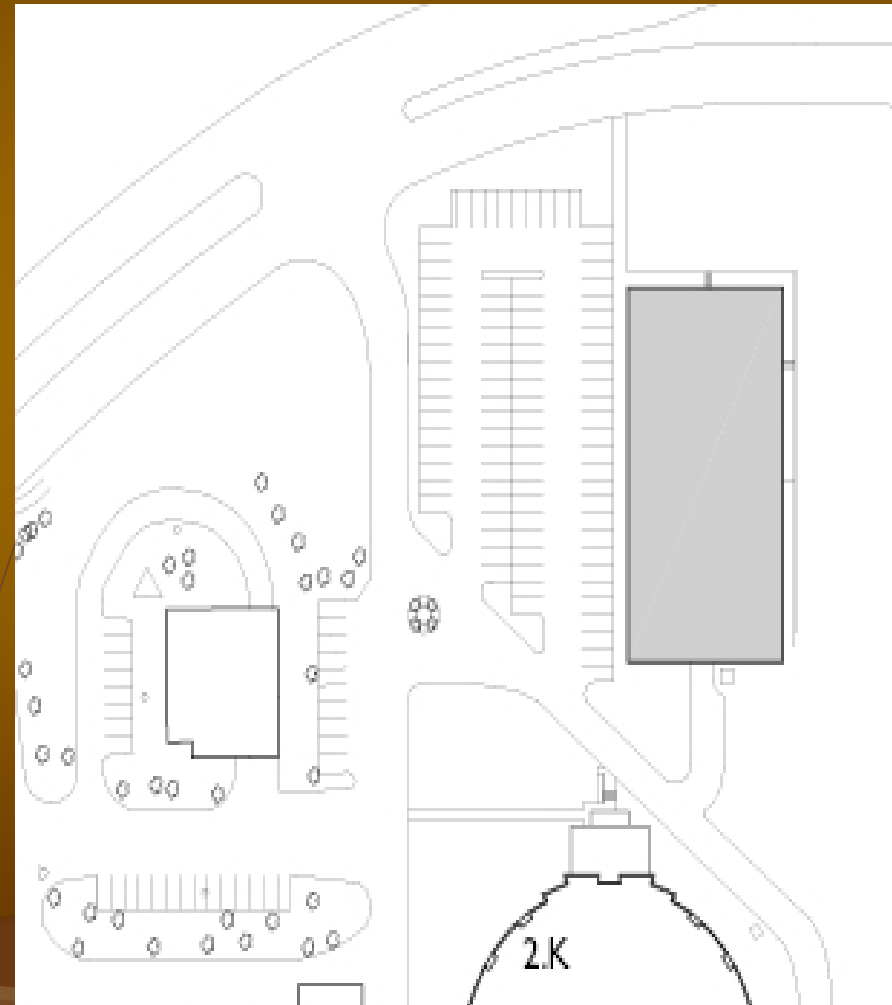

Work Release Building

- 11 dormitory style sleeping areas
- 4 double bunks to each sleeping area
- 8 inmates per area
- 1 Deputy Sheriff supervising per shift
- Minimum Security Inmates

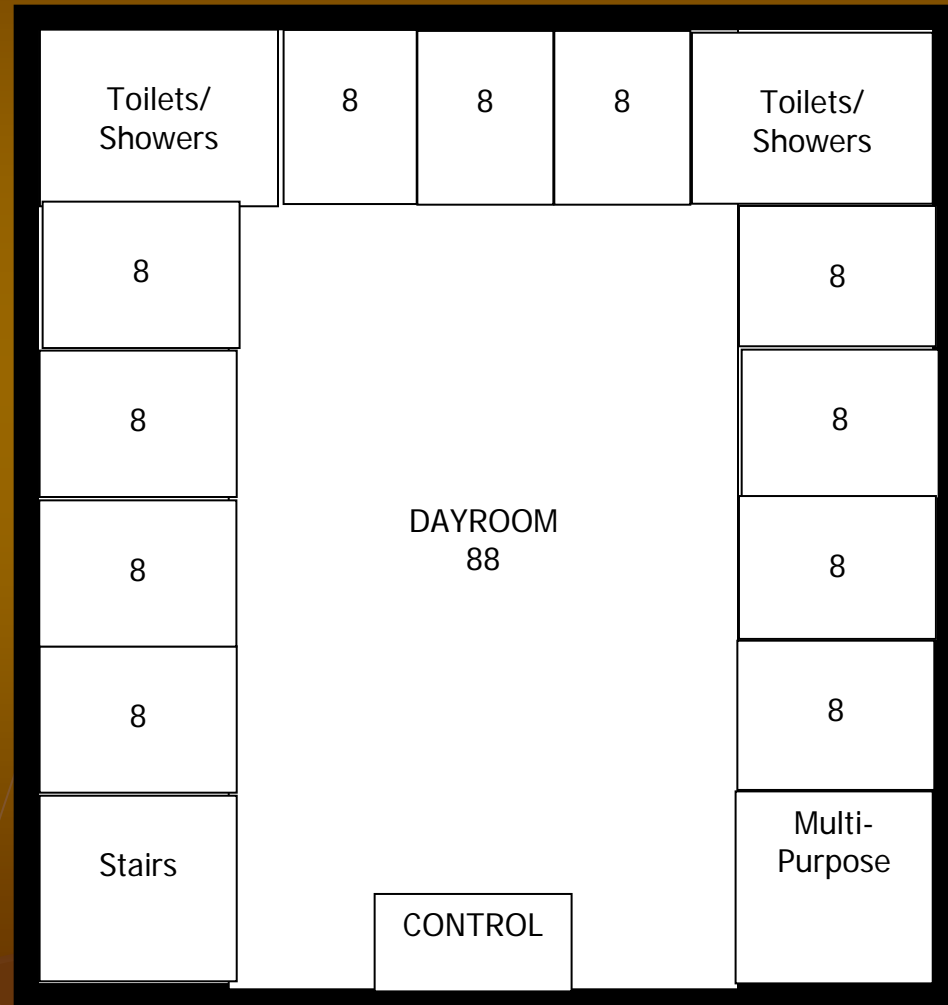

Lobby

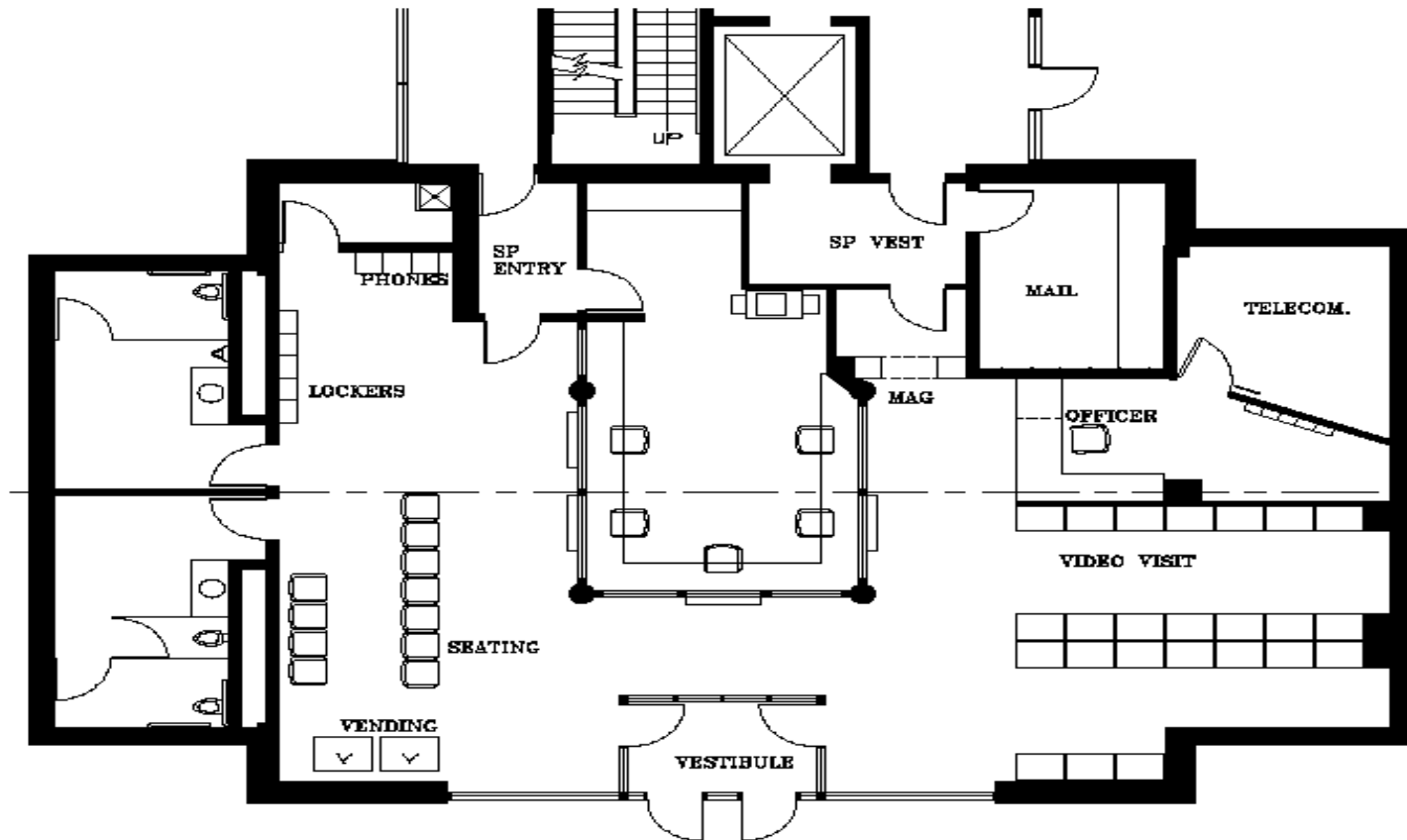

JEFFERSON COUNTY DETENTION CENTER PUBLIC LOBBY REMODEL
OPTION C

Total Project Cost Model

- Phase One - \$53,457,800
 - 646 New Jail Beds (Work Release and Community Corrections)

New cost: \$46,557,800 to \$48,857,800 (2009)

- Phase Two - \$89,693,600 (if necessary)
 - 688 New Jail Beds
 - Ability to go up another 574, if needed
- Total could go over 3,100 beds

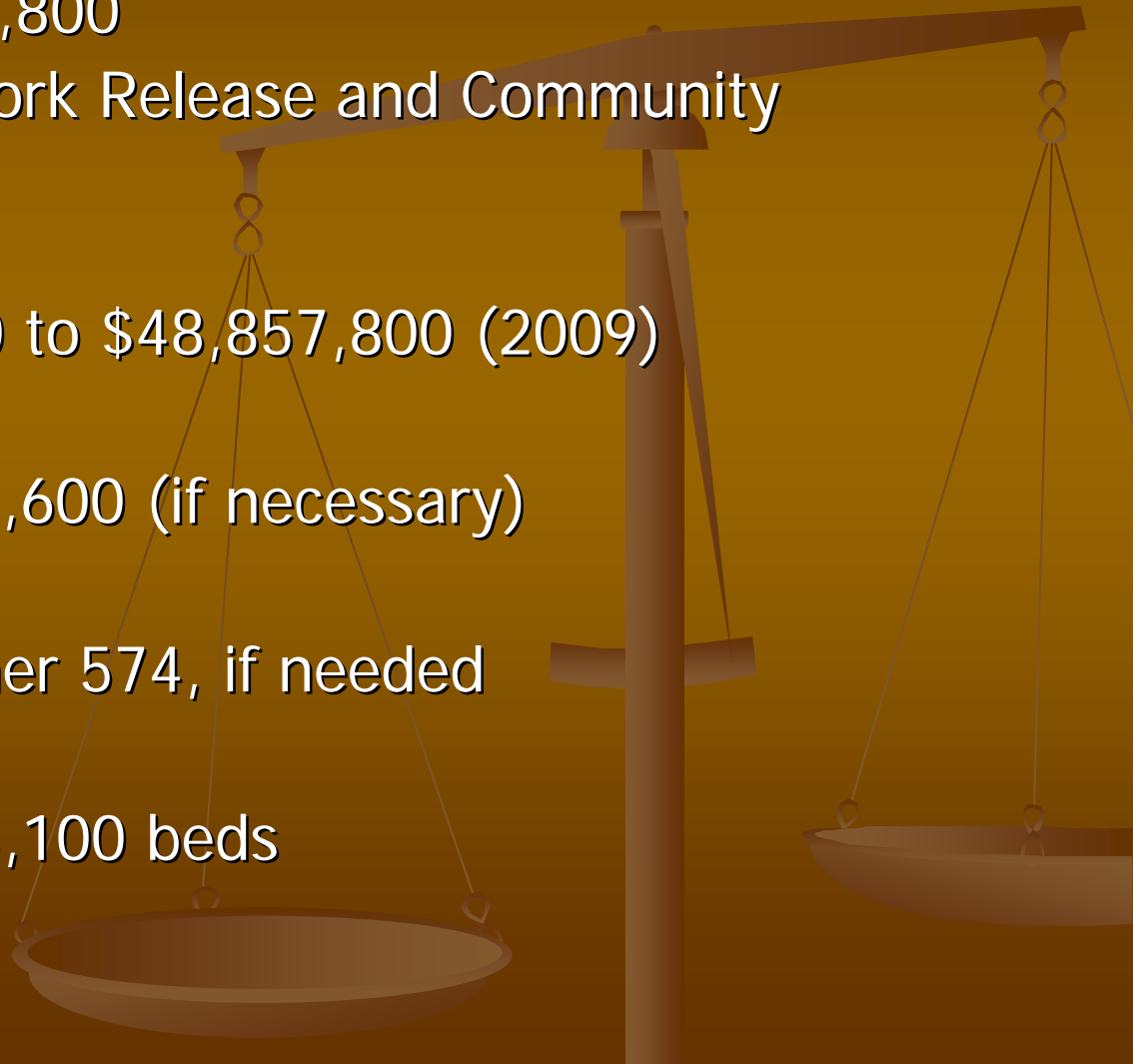

How Do We Pay For Phase One? Some Ideas:

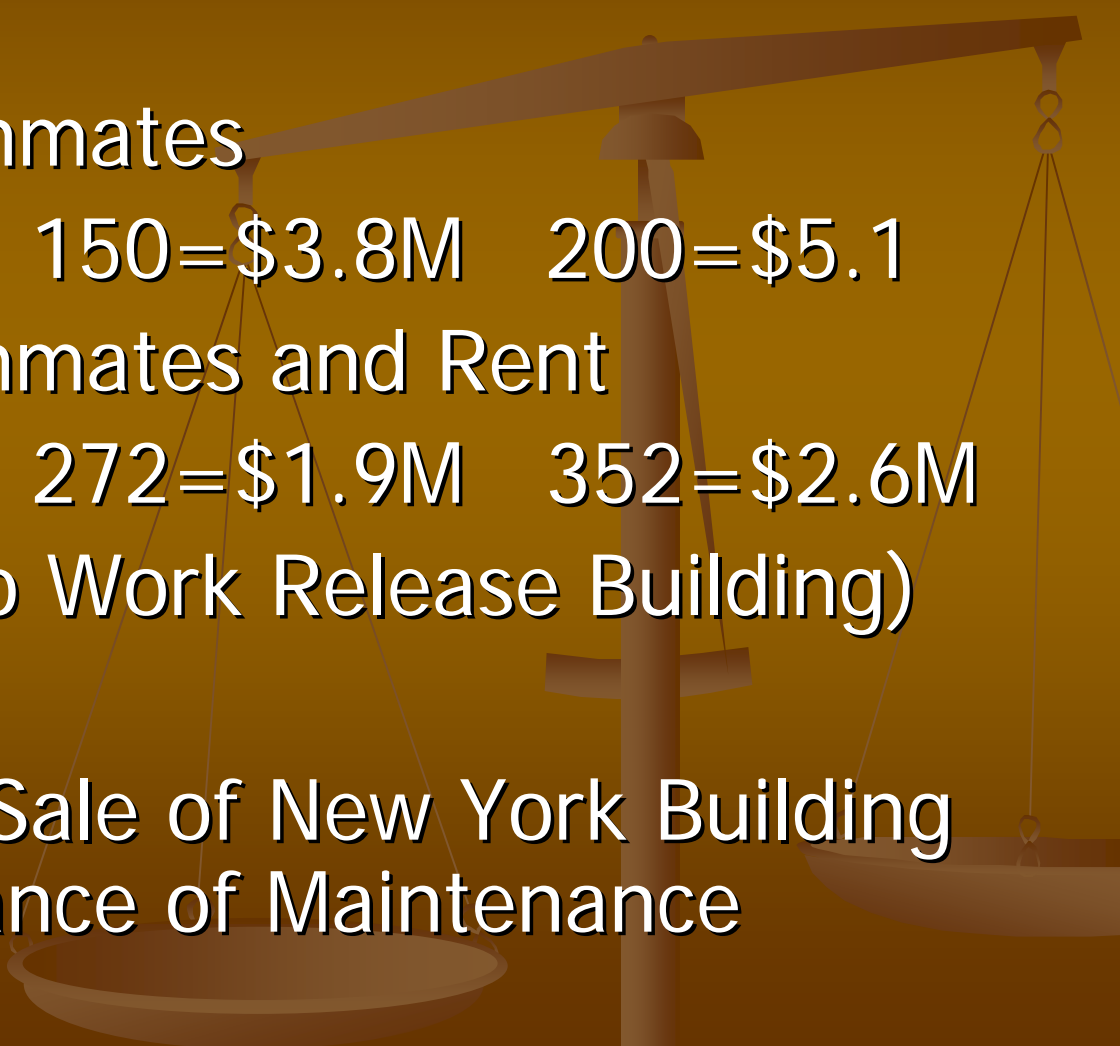
- Maintain USM Inmates
 - 125=\$3.2M 150=\$3.8M 200=\$5.1
 - Increase W/R Inmates and Rent
 - 192=\$1.4M 272=\$1.9M 352=\$2.6M
 - Move ICCS (Into Work Release Building)
 - \$1.0M
 - Proceeds From Sale of New York Building and Cost Avoidance of Maintenance
- 

Controlling Growth



- Avoid the “Build it and they will come”
- Modify Arrest Standards, Bonding Schedule, Sentencing (Decisions Based on Public Safety!!)
- Reduce FTA's
- Expanding Programs, Reduce Recidivism
 - - Inmate-Outmate
 - - Pre-Trial Services Supervision
- Jail Use Plan – Who needs to be in Jail?

What Could The ADP Be?

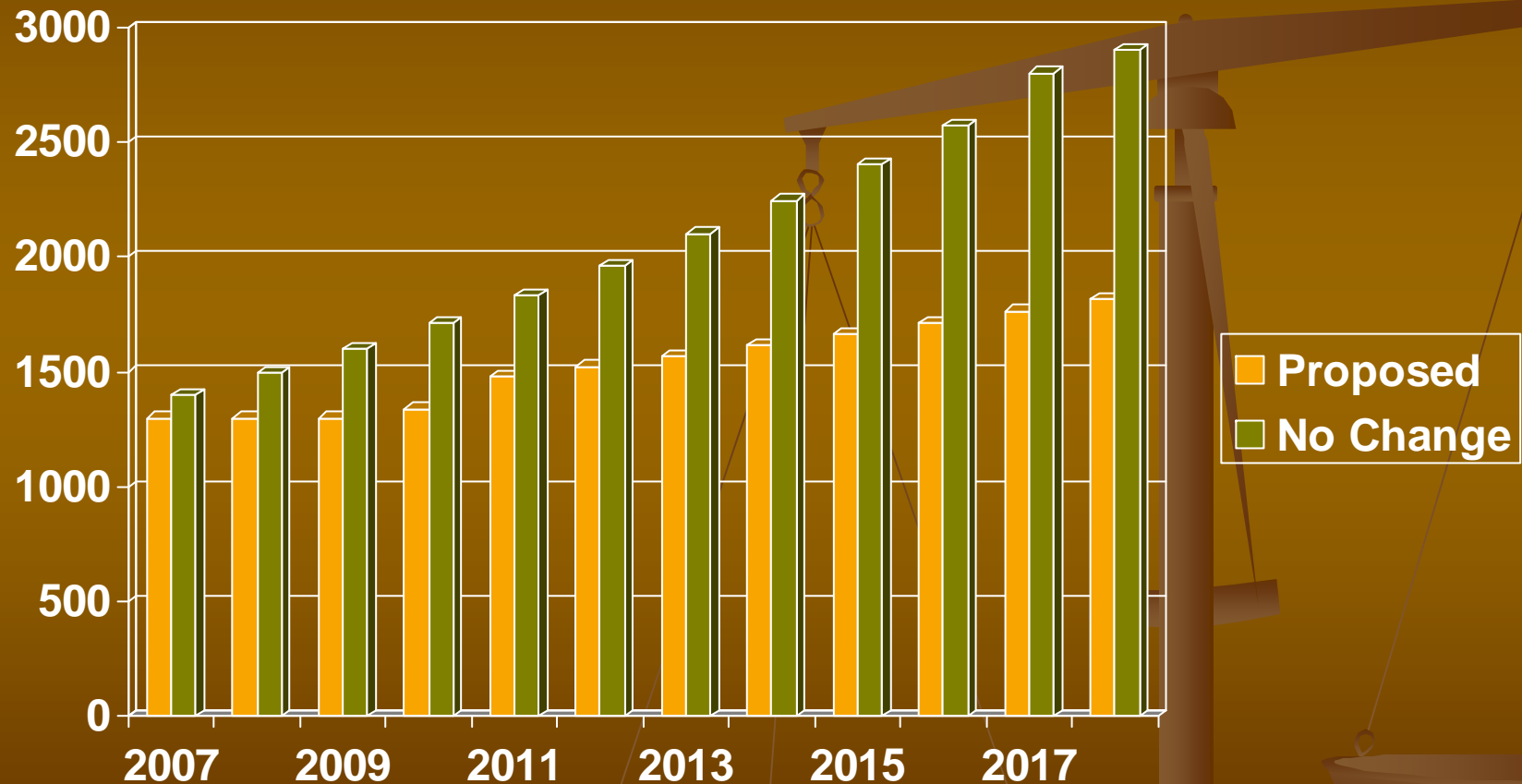

Questions ?

